

Fairways at Maui Lani Photos

Taken July 16, 2019

RECEIVED AT EDB MEETING ON 7/25/2019
Committee Chair Rawlins-Fernandez

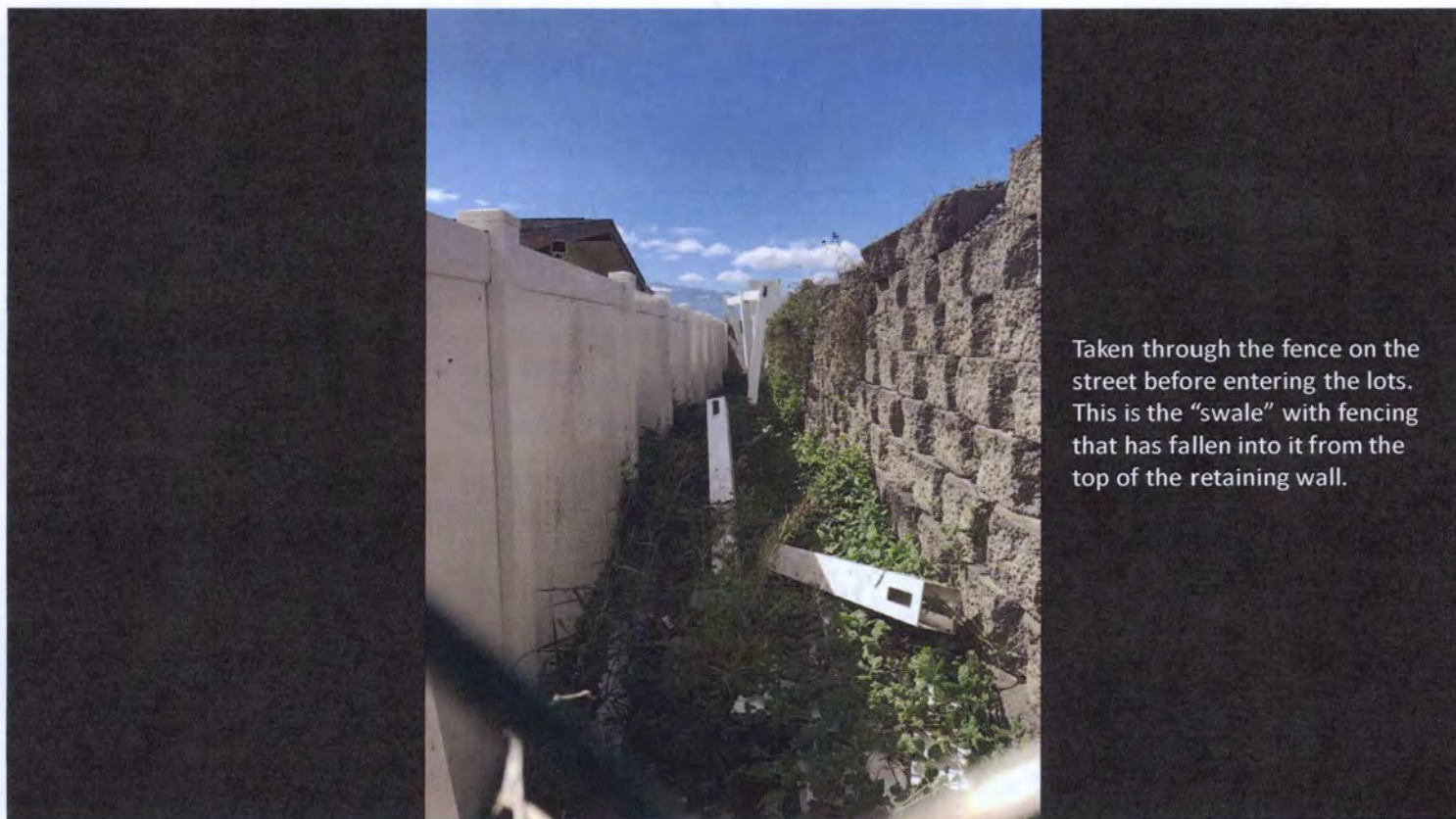

Taken through the fence on the street before entering the lots. This is the "swale" with fencing that has fallen into it from the top of the retaining wall.



Cement blocks have fallen off the top of the retaining wall, right on the corner of the Kea Street entrance.



Street entrance cement retaining wall blocks that have fallen with fence posts still attached.



The view of the retaining wall to the right hand side of the Kea Street entrance. The wall and fencing falling down along the length of the wall.



This photo was taken as we began to walk the property. The retaining wall blocks have fallen in 2-3 foot sections.



A view from the top of the retaining wall into the swale, showing fencing and cement blocks that have fallen.



A view of the swale with debris from the retaining wall, right behind a local childcare provider's home.



An expanded view of the same area behind childcare provider's home. Resident alleges debris that has flown over the fence, was discarded by the homeowner and that RFSs were filed for this issue with no assistance.



A view of the swale and debris that has not been cleared.



Cement block and the fencing of the retaining wall that are on the verge of falling.



A view from the top of the retaining wall showing debris and the broken fencing and missing parts of the retaining wall.



A photo showing the amount of mortar placed on one of the cement blocks that make up the retaining wall.



A photo showing the tallest portion of the retaining wall above the drainage basin. Person in the photo is 5'6".



A view from Palama Street, showing the height of the fill compared to the ground height of this residence. Portions of fencing in disrepair comprise their mountain views.



Missing slats on the tallest side of the drainage area fencing. The fence looks like it is supposed to prohibit entry to the area, limiting liability of anyone falling into the drainage basin and/or possible theft.



Fencing along the drainage basin in a state of disrepair.



Fencing along the drainage basin in a state of disrepair.



Fencing along the drainage basin in a state of disrepair. Another view from the street.



This picture is showing the distance from the fencing above the drainage basin to the retaining wall drop off.



Unlocked and exposed valves at the top of drainage basin next to water meters.



Fencing on the wall bordering the bottom of the drainage basin, further to the left of the previous photo.



Fencing on the wall bordering the bottom of the drainage basin, to the left of a large mango tree, which has fallen. Fallen fencing is overgrown with vegetation and does not limit access or entry.



Fencing on the wall bordering the bottom of the drainage basin, which has fallen. Fallen fencing is overgrown with vegetation.



Fencing on the wall bordering the bottom of the drainage basin, which has fallen. Photo taken from the far corner of the drainage basin to show the area to the right of the mango tree, where fallen fencing is overgrown with vegetation.



A photo of the bottom of the drainage basin. The red arrow is indicating the uncovered manhole, there were also other manholes whose covers looked like they had been opened and not secured properly.



A photo showing the top of the drainage basin and the height difference from the top of the fill and the neighbors' yards, which were once the same height.



A man hole that was open and uncovered in the drainage basin, while not able to see in the photo there were articles of clothing and food containers in the man hole that showed people have been going down into these areas unimpeded.



Broken fence post left exposed with rusted and sharp metal sticking out of the ground.



A pile of piping and supplies that has been left out in the open on the outside of the drainage basin security wall.



Overgrown trees spanning the length of the road showed that basic maintenance is not being done.



A work station of some kind set up on the open lot on the opposite side of the drainage basin.



A photo showing a pile of gravel and machinery that is being stored on the roadway of the lots.

Concerns - Fairway Lots Overview

Infrastructure Concerns	Maintenance & Safety Concerns
Retaining wall construction	Falling fencing
Height of fill	Debris from fencing falling and flying in high winds
Composition of the fill (possibility of toxicity)	Equipment/ material storage
Density of fill/ was it properly compacted	Lack of maintenance of equipment/ grounds
Possible cracks in drainage pipes	Signs of trespassing and entering manholes in drainage basin
Drainage basin compliance/ sanitary sewer concerns	Broken fencing leaving exposed metal in the ground
Swale construction	Open and exposed water valves; very little to no drainage