



Maui County Service Center

Keith Regan & Alan Murata | County of Maui

RECEIVED AT BF MEETING ON 3-27-18
Submitted by Managing Director, BF-44

Project Location

- Central Maui
- Close to Hana Highway
- Growing commercial/industrial area
- Room for growth/expansion
- Convenient location for citizens



Project Specs

- Lead Department: Management
- Project Lead: Alan Murata
- Consultant: Group 70 (\$1.792M)
- Land Area: 4.11 acres (\$7.11M)
 - Facility / Parking: 2.7 acres
 - Open: 1.4 acres
 - Purchase included 30 acres in Paia
- Facility (\$25M)
 - 58,000 sf
 - Parking: 145 stalls

Site Plan

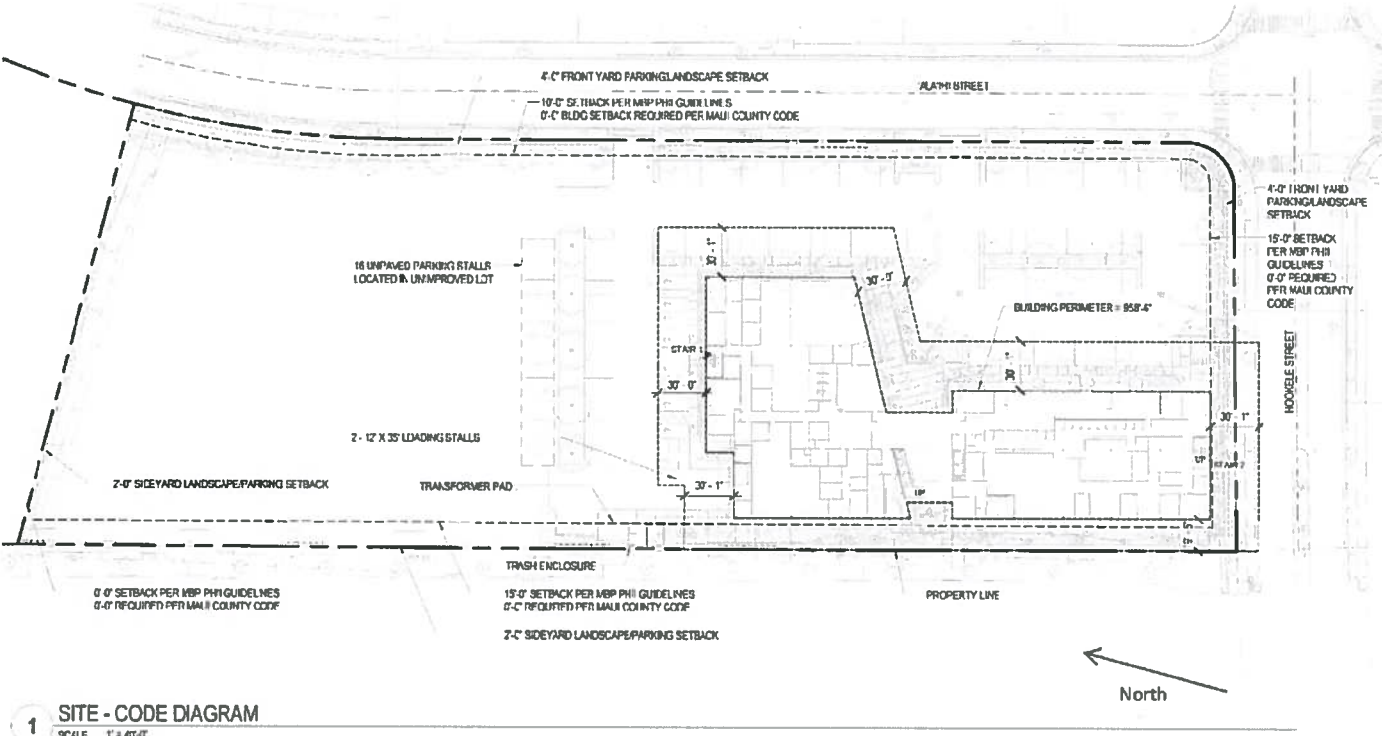

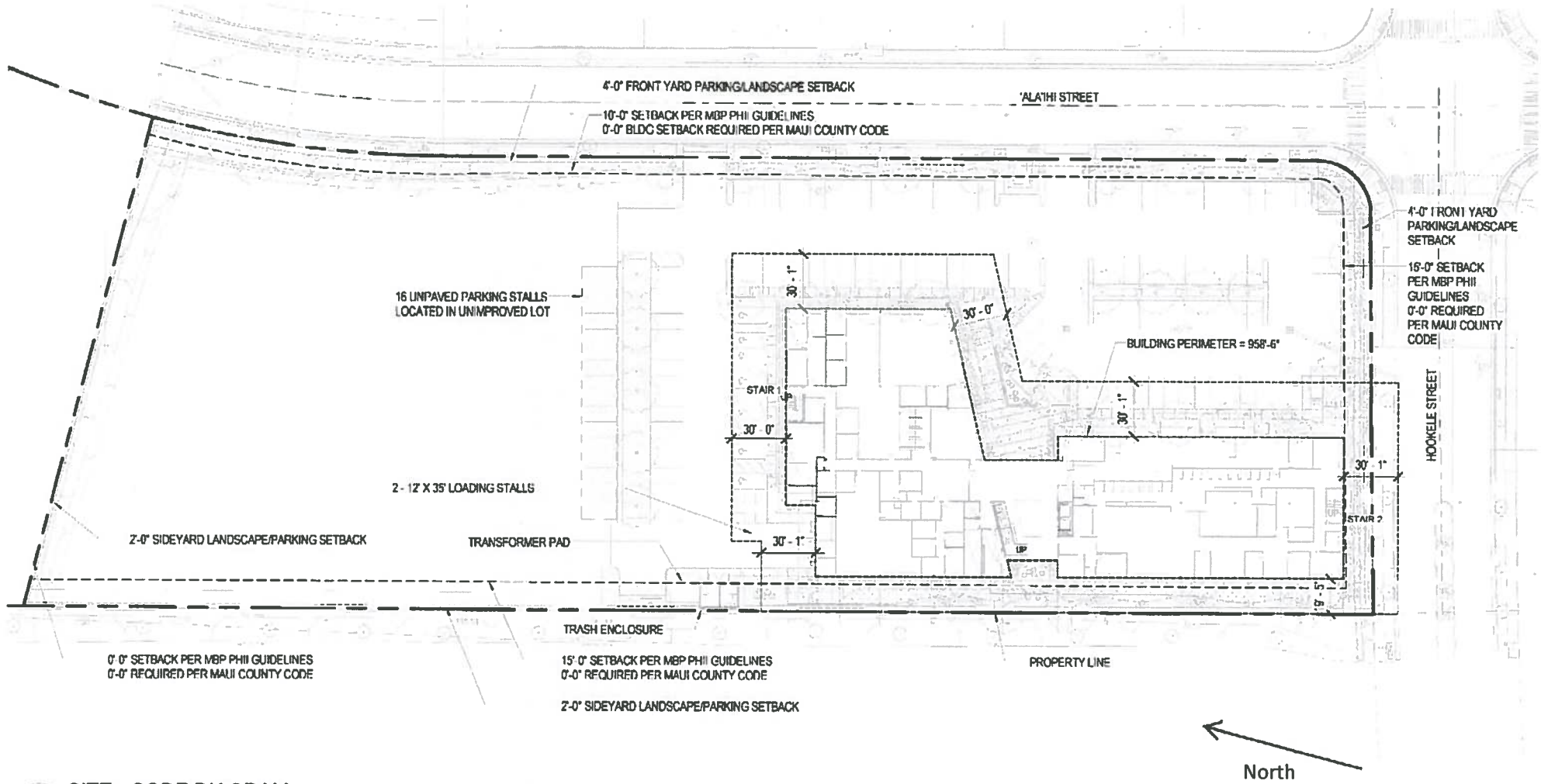

1 SITE - CODE DIAGRAM
SCALE. 1" = 40'-0"

Departments/Functions

- Finance (10,500 sf)
 - DMVL
- Housing & Human Concerns (11,500 sf)
 - Admin
 - Aging
 - Early Childhood
 - Grants
 - Homeless
 - Immigration
 - Section 8
 - Volunteer Center
- Public Works (4,300 sf)
 - DSA Inspectors
- Shared Conference Rooms (2,000 sf)
- Available Space (16,000 sf – 2nd Floor)

Project Timeline



Questions?