

HFC Committee

From: Karla Peters <Karla.Peters@co.maui.hi.us>
Sent: Wednesday, February 13, 2019 1:21 PM
To: HFC Committee
Cc: John Buck; Lisa Sakumoto
Subject: 2/14 HFC Meeting - Parks Presentation
Attachments: 02142019_HFC Committee Presentation Final.ppsx

Aloha,

Attached is the Department's presentation on the 2/14/19 meeting agenda items. Please let me know if you have any questions.

Mahalo!
Karla

Karla H. Peters

Acting Director
Parks & Recreation
County of Maui
700 Hali'a Nakoia St., Unit 2
Wailuku, Maui, Hawaii 96793
Office: [\(808\) 270-7230](tel:8082707230)
Fax: [\(808\) 270-7934](tel:8082707934)
karla.peters@co.maui.hi.us

Our Mission: "Provide safe, satisfying and cost effective recreational opportunities for the residents of and visitors to Maui County."

Kanahā Beach Park Master Plan



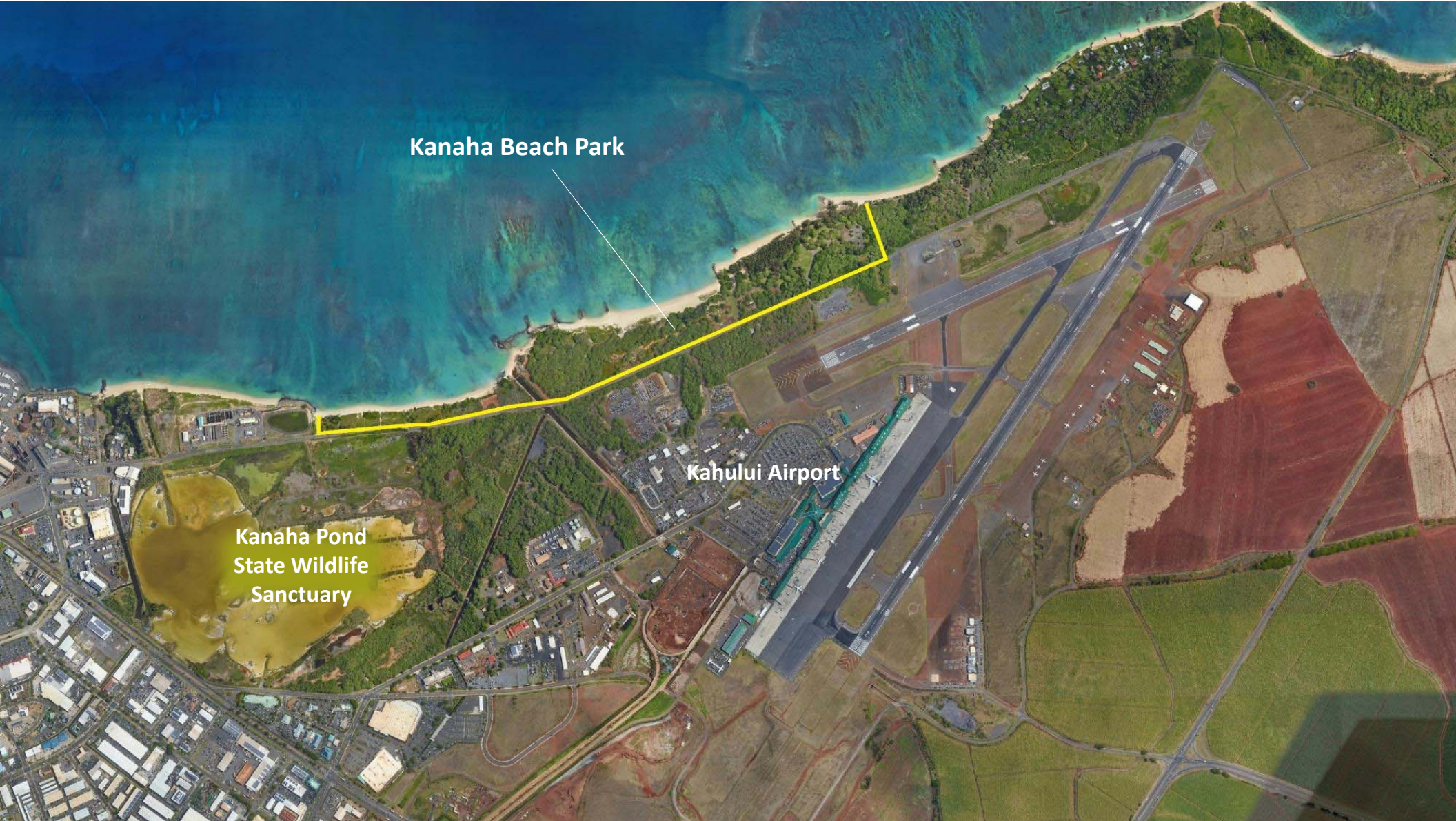

Kanaha Beach Park

Kahului Airport

**Kanaha Pond
State Wildlife
Sanctuary**

Planning Process

April 2015 – October 2018

- Technical studies
- On-site park survey
- Public workshops
- Parking study
- Focus group





Major Planning Challenges

- Coastal erosion
- Poor circulation for pedestrians and vehicles
- Degredation of natural resources
- Safety, security, user conflicts
- Shortage of parking, toilets, and lifeguard facilities
- Coastal erosion

Key Strategies

- Accommodate a variety of recreational activities
- Develop new recreation areas to meet future demand
- Improve circulation for all modes of travel
- Protect natural resources and coastal environment
- Improve and expand parking
- Improve security and safety

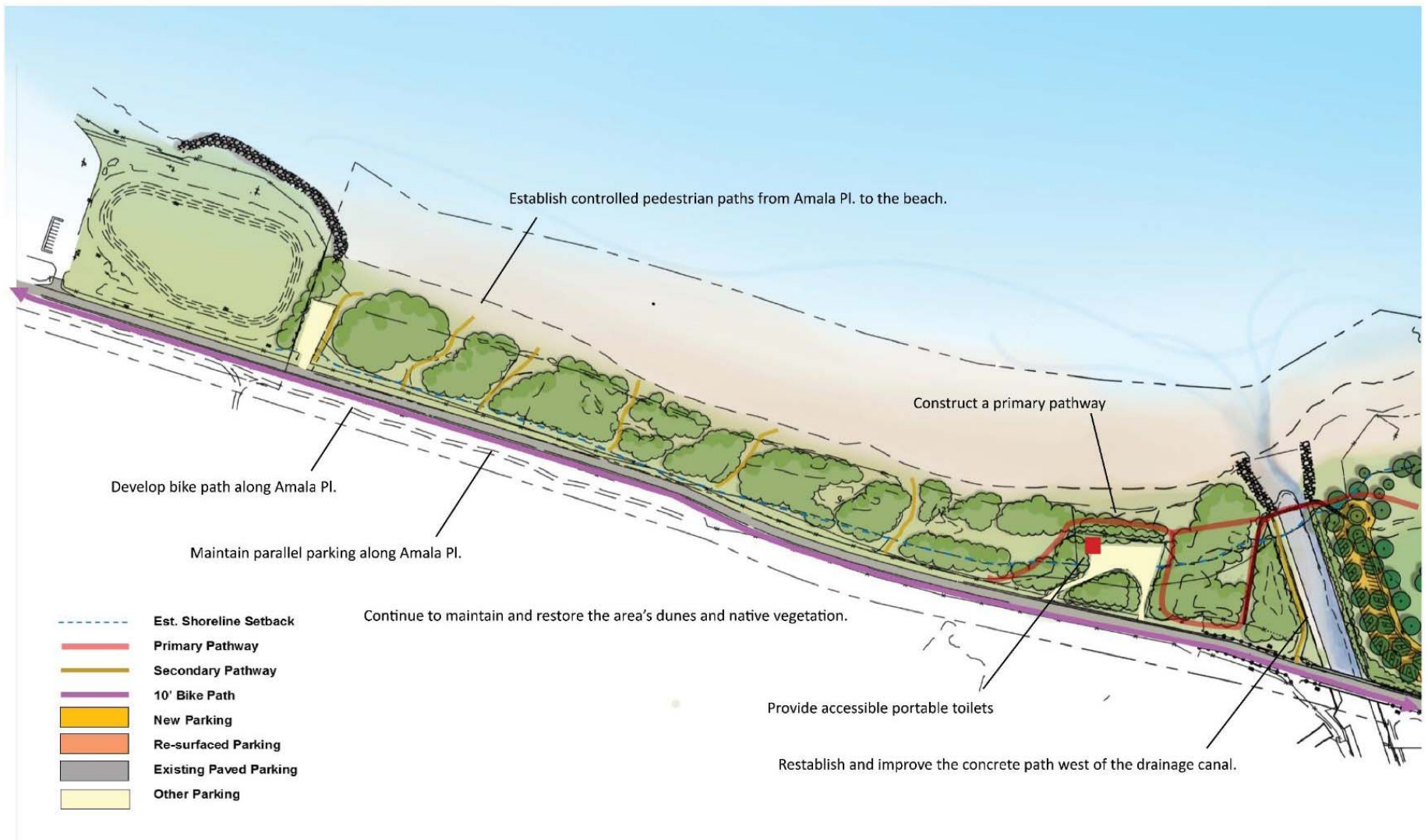

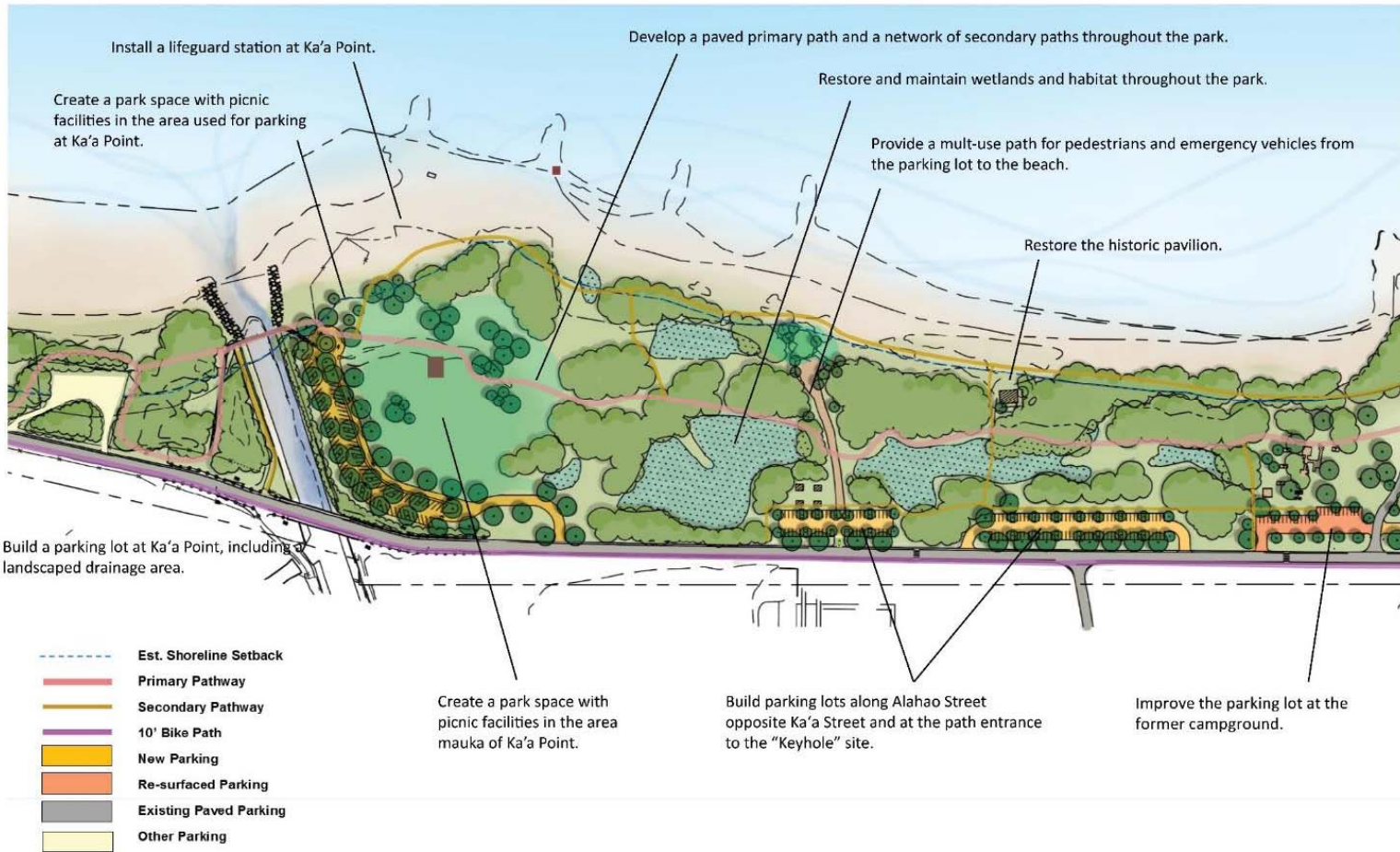



Preliminary Cost Estimate (2018 dollars)

Sub-Total	\$ 13,900,000
Contingency (25%)	3,500,000
TOTAL	\$ 17,400,000

Next Steps

- Short-term projects
- Environmental Assessment (EA)
- Management Group

Mahalo!

