

Received at 11/02/2023 ESCS Committee meeting from Ke'eaumoku Kapu

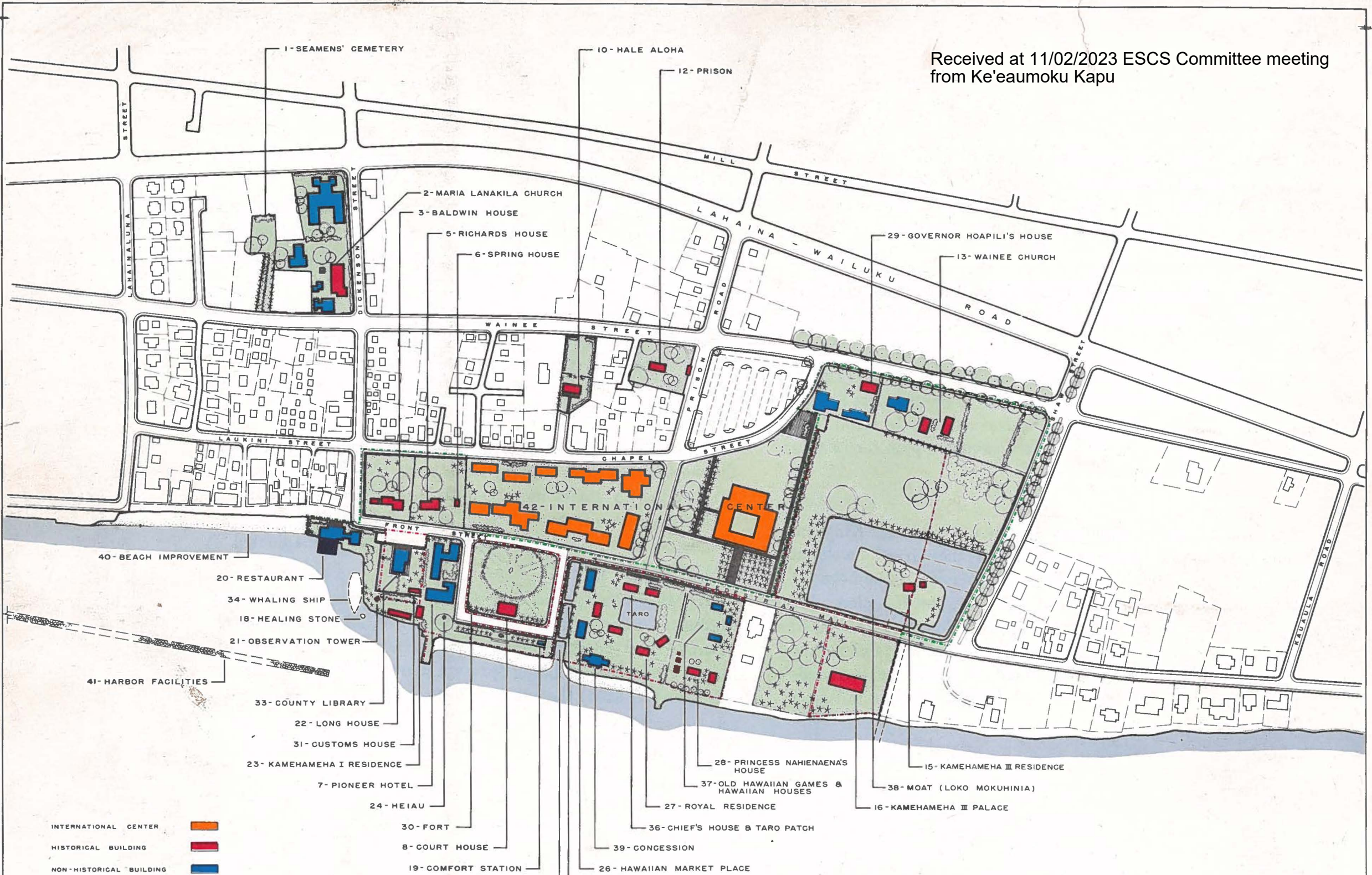

### RESTORATION PLAN - LAHAINA, MAUI

PREPARED BY: COMMUNITY PLANNING INC., 233 MERCHANT STREET, HONOLULU, HAWAII

- INTERNATIONAL CENTER
- HISTORICAL BUILDING
- NON-HISTORICAL BUILDING
- CORE AREA
- WATER
- PROJECTED AREA
- PUBLIC OWNED LAND

P A G E O F T W O

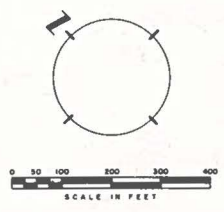

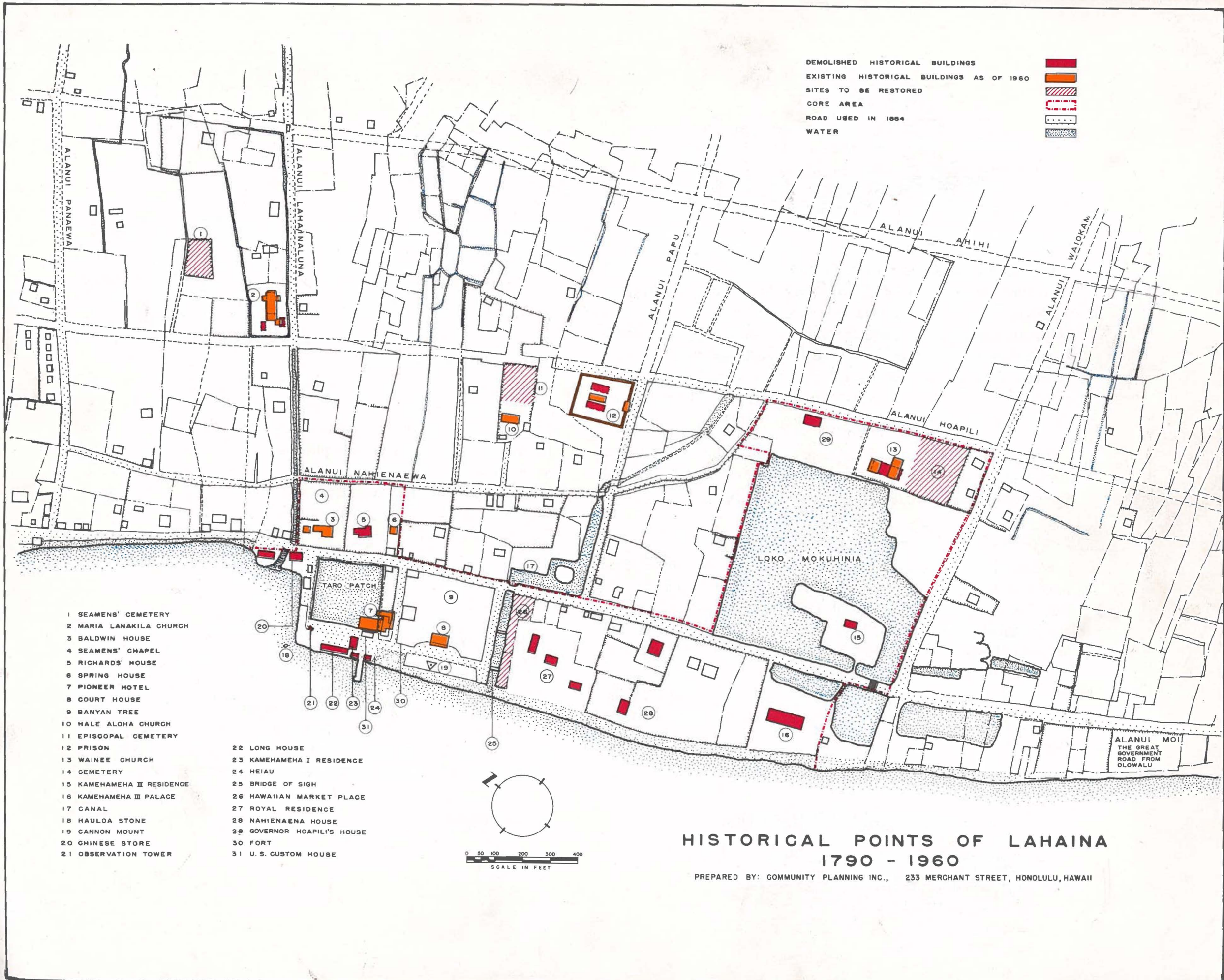

- 1 SEAMENS' CEMETERY
- 2 MARIA LANAKILA CHURCH
- 3 BALDWIN HOUSE
- 4 SEAMENS' CHAPEL
- 5 RICHARDS' HOUSE
- 6 SPRING HOUSE
- 7 PIONEER HOTEL
- 8 COURT HOUSE
- 9 BANYAN TREE
- 10 HALE ALOHA CHURCH
- 11 EPISCOPAL CEMETERY
- 12 PRISON
- 13 WAINEE CHURCH
- 14 CEMETERY
- 15 KAMEHAMEHA III RESIDENCE
- 16 KAMEHAMEHA III PALACE
- 17 CANAL
- 18 HAULOA STONE
- 19 CANNON MOUNT
- 20 CHINESE STORE
- 21 OBSERVATION TOWER

- 22 LONG HOUSE
- 23 KAMEHAMEHA I RESIDENCE
- 24 HEIAU
- 25 BRIDGE OF SIGH
- 26 HAWAIIAN MARKET PLACE
- 27 ROYAL RESIDENCE
- 28 NAHIENAENA HOUSE
- 29 GOVERNOR HOAPILI'S HOUSE
- 30 FORT
- 31 U.S. CUSTOM HOUSE

## HISTORICAL POINTS OF LAHAINA 1790 - 1960

PREPARED BY: COMMUNITY PLANNING INC., 233 MERCHANT STREET, HONOLULU, HAWAII