

# KALANA O MAUI CAMPUS PARKING

Department of Management  
February 24, 2020  
Water, Infrastructure and Transportation Committee of the County Council

## PARKING MANAGEMENT PLAN

The Department of Management is working to create additional parking supply on campus, improve the management of parking assets, and locate fleet vehicles to improve efficiency.

**SUPPLY-** The Department requested a budget amendment to enable the two County owned lots makai of campus, on Kaohu Street, to be converted into temporary parking. The temporary materials will enable the County to create an additional 56 stalls while keeping options open for future office expansions and permanent parking solutions.

**ASSET MANAGEMENT-** The Department is researching new ways to manage employee parking.

**DEMAND MANAGEMENT -** The new Wailuku Town employee shuttle will provide an alternative for commuters and reduce the number of single occupant vehicles needing to park.

**FLEET -** Some vehicles go on multiple runs a day and some sit for days without moving. The Department is analyzing the best use and location for all fleet vehicles at Kalana O Maui.

## PARKING BY THE NUMBERS

*Expanding existing parking areas and moving County divisions to the Service Center will increase the campus parking supply.*

### Parking Expansion Area

- Create 56 new parking stalls

### Service Center

- 27 Fleet Vehicles to relocate
- 48 Employees to Relocate

Total of 75 less cars

Together these actions will open up 131 stalls on and around the County campus. Prioritizing the greatest needs for these stalls will be the next step.

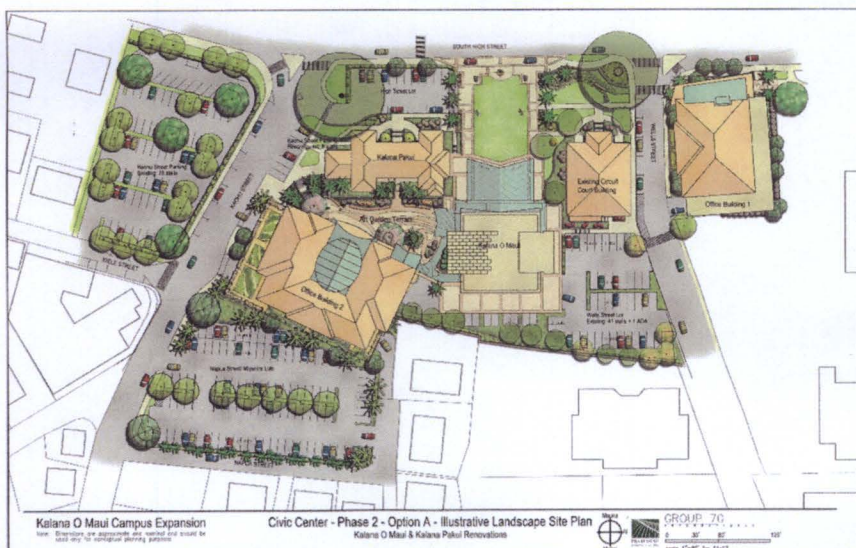

Erin Wade RECEIVED AT WIT MEETING ON 02-24-2020  
(MANAGING DIRECTOR)



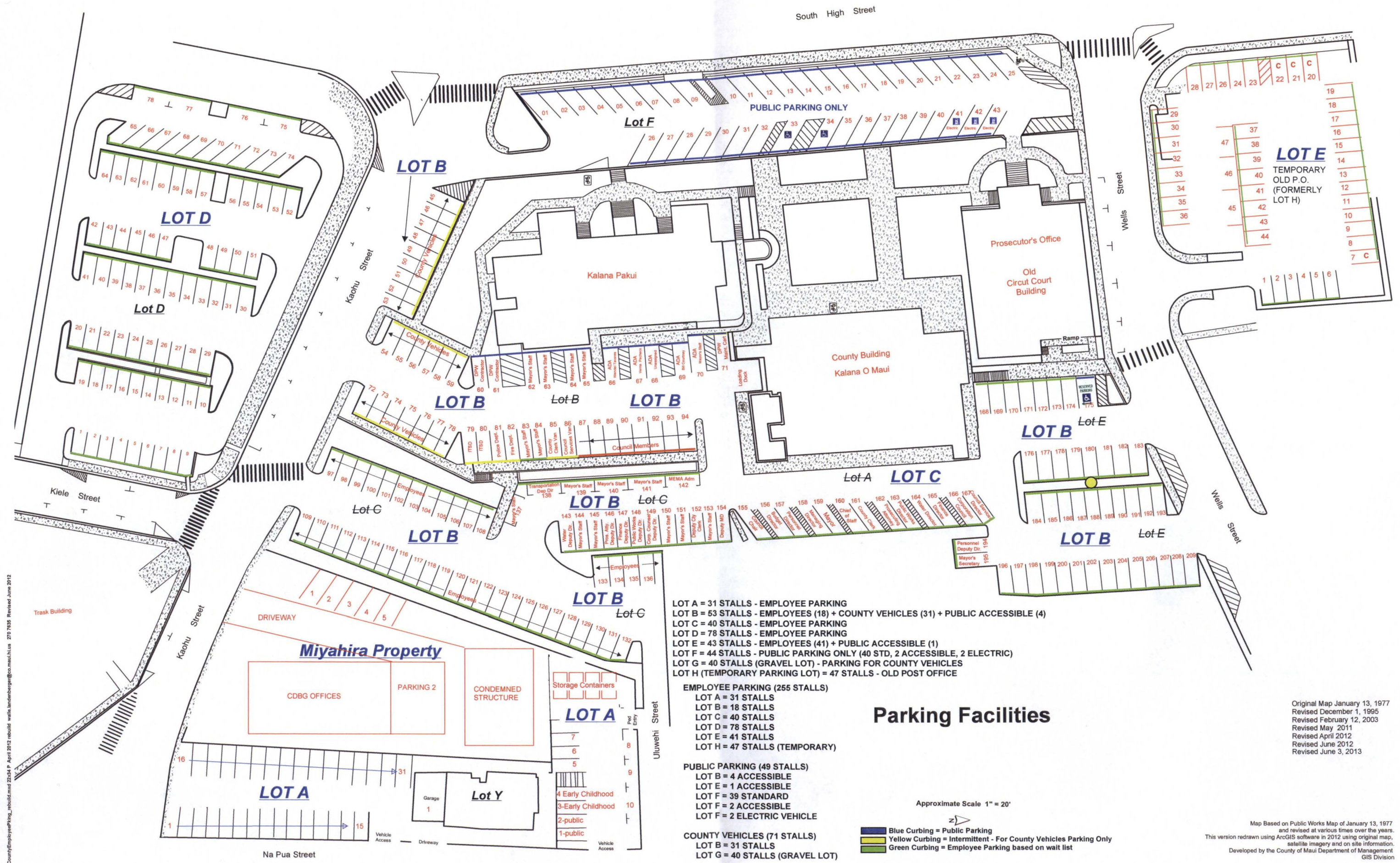

- LOT A = 31 STALLS - EMPLOYEE PARKING
- LOT B = 53 STALLS - EMPLOYEES (18) + COUNTY VEHICLES (31) + PUBLIC ACCESSIBLE (4)
- LOT C = 40 STALLS - EMPLOYEE PARKING
- LOT D = 78 STALLS - EMPLOYEE PARKING
- LOT E = 43 STALLS - EMPLOYEES (41) + PUBLIC ACCESSIBLE (1)
- LOT F = 44 STALLS - PUBLIC PARKING ONLY (40 STD, 2 ACCESSIBLE, 2 ELECTRIC)
- LOT G = 40 STALLS (GRAVEL LOT) - PARKING FOR COUNTY VEHICLES
- LOT H (TEMPORARY PARKING LOT) = 47 STALLS - OLD POST OFFICE

- EMPLOYEE PARKING (255 STALLS)**
- LOT A = 31 STALLS
  - LOT B = 18 STALLS
  - LOT C = 40 STALLS
  - LOT D = 78 STALLS
  - LOT E = 41 STALLS
  - LOT H = 47 STALLS (TEMPORARY)

- PUBLIC PARKING (49 STALLS)**
- LOT B = 4 ACCESSIBLE
  - LOT E = 1 ACCESSIBLE
  - LOT F = 39 STANDARD
  - LOT F = 2 ACCESSIBLE
  - LOT F = 2 ELECTRIC VEHICLE

- COUNTY VEHICLES (71 STALLS)**
- LOT B = 31 STALLS
  - LOT G = 40 STALLS (GRAVEL LOT)

## Parking Facilities

Approximate Scale 1" = 20'

- Blue Curbing = Public Parking
- Yellow Curbing = Intermittent - For County Vehicles Parking Only
- Green Curbing = Employee Parking based on wait list

Original Map January 13, 1977  
 Revised December 1, 1995  
 Revised February 12, 2003  
 Revised May 2011  
 Revised April 2012  
 Revised June 2012  
 Revised June 3, 2013

Map Based on Public Works Map of January 13, 1977 and revised at various times over the years. This version redrawn using ArcGIS software in 2012 using original map, satellite imagery and on site information. Developed by the County of Maui Department of Management GIS Division