

# Resolution

No. 22-117

AMENDING RESOLUTION 18-210 AND AUTHORIZING THE DISPOSITION OF APPROXIMATELY 33.373 ACRES OF COUNTY REAL PROPERTY LOCATED IN LAUNIUPOKO, MAUI, HAWAII, TO THE DEPARTMENT OF TRANSPORTATION, STATE OF HAWAII, FOR THE HONOAPIILANI HIGHWAY REALIGNMENT, PHASE 1B-2

WHEREAS, the COUNTY OF MAUI (hereinafter the “County”) is the owner of real property identified for real property tax purposes as tax map key number (2) 4-7-001:030 (por.) (the “Property”), as described in Exhibit “A-1” and as shown on Exhibit “A-2”, attached hereto and incorporated by reference herein; and

WHEREAS, by way of Resolution 18-210, the Council authorized the disposition of the Property to the State of Hawaii, Department of Transportation (“DOT”), for the purpose of the Honoapiilani Highway Realignment, Phase 1B-2 (the “Lahaina Bypass”); and

WHEREAS, Resolution 18-210 attached an incorrect Exhibit “1”; and

WHEREAS, the Property was acquired by the County pursuant to Resolution No. 13-151, which included an appraisal reflecting a negotiated price adjustment in consideration of the future transfer to the DOT of the right of way for the Lahaina Bypass project; and

WHEREAS, the State of Hawaii has agreed to pay the County the sum of \$1,251,798 for additional acreage used by the DOT to construct the Lahaina Bypass; and

WHEREAS, Section 13-14 of the Charter provides for cooperation with the State of Hawaii; and

WHEREAS, pursuant to Sections 3.44.020, 3.44.030, 3.44.050, and 3.44.070, Maui County Code, the Council may authorize the disposition of County real property in fee simple by resolution upon finding that it is in

**Resolution No.** 22-117

INTRODUCED BY:

A handwritten signature in black ink, appearing to read "Chris Lee", is written over a horizontal line.

Upon the request of the Mayor.

**Resolution No. 22-117**

the public interest to do so, and may waive public auction, public hearing, and appraisal, provided that such resolution is approved by two-thirds of its members; now, therefore,

BE IT RESOLVED by the Council of the County of Maui:

1. That the Council hereby finds that it is in the public interest to grant the Property to the State of Hawaii, Department of Transportation, and waives public hearing, public auction, and an appraisal of the Property; and

2. That pursuant to Section 3.44.020, Maui County Code, the Council hereby amends Resolution 18-210 and approves the disposition of the Property as described in and shown on Exhibits "A-1" and "A-2"; conditioned upon the County's receipt of payment by the State of Hawaii in the amount of \$1,251,798 for the additional area used for the Lahaina Bypass; and

3. That the proceeds shall be deposited to the Open Space, Natural Resources, Cultural Resources, and Scenic Views Preservation Fund; and

4. That it does hereby authorize the Mayor of the County of Maui, or the Mayor's duly authorized representative, to execute all necessary documents in connection with the disposition of the Property; and

5. That certified copies of this Resolution be transmitted to the Mayor, the Director of Finance, the Director of Public Works, the Director of Parks and Recreation, the Corporation Counsel, and the State of Hawaii, Department of Transportation.

**Resolution No. 22-117**

APPROVED AS TO FORM  
AND LEGALITY:

A handwritten signature in black ink, appearing to read 'R. Thomson', is written over a horizontal line.

RICHELLE M. THOMSON  
First Deputy Corporation Counsel  
County of Maui  
LF 2018-0229

EXHIBIT "A-1"

HONOAPIILANI HIGHWAY REALIGNMENT, PHASE 1B-2  
Hokiokio Place to Vicinity of Olowalu  
Federal Aid Project No. NH-030-1(051)

PARCEL 1 (Revision 2)

Being a portion of Royal Patent 1358, Land Commission Award 82 to Thomas Phillips

Being also a portion of Lot 7 of the Launiupoko (Large-Lot) Subdivision No. 2 (LUCA File No. 4.837).

Land Situated at Launiupoko, Lahaina, Maui, Hawaii

Beginning at the Northeast corner of this piece of land, on the Northeast side of Honoapiilani Highway Realignment, Phase 1B-2, Hokiokio Place to Vicinity of Olowalu, Federal Aid Project No. NH-030-1(051) and on the South side of Kai Hele Ku Street (Lot B-2) Mahanalua Subdivision, the coordinates of said point of beginning referred to Government Survey Triangulation Station "Laina" being 19,281.19 feet South and 6,703.63 feet East, thence running by azimuths measured clockwise from true South:

1. Along the Northeast side of Honoapiilani Highway Realignment, Phase 1B-2, Project No. NH-030-1(051), along Lot 10-C of the Makila Nui Subdivision on a curve to the left with a radius of 30.00 feet, the chord azimuth and distance being:  
207° 29' 46" 42.80 feet;
2. 341° 59' 16" 385.86 feet along the Northeast side of Honoapiilani Highway Realignment, Phase 1B-2, Project No. NH-030-1(051), along Lot 10-C of the Makila Nui Subdivision;
3. Thence along same on a curve to the left with a radius of 2,784.79 feet, the chord azimuth and distance being:  
338° 04' 19" 380.35 feet;

HONOAPIILANI HIGHWAY REALIGNMENT, PHASE 1B-2  
Federal Aid Project No. NH-030-1(051)  
Parcel 1

4. Thence along the Northeast side of Honoapiilani Highway Realignment, Phase 1B-2, Project No. HN-030-1(051), along the remainder of Lot 7 of the Launiupoko (Large-Lot) Subdivision No. 2 on a curve to the left with a radius of 2,864.67 feet, the chord azimuth and distance being:  
  
317° 13' 23.5" 2,059.24 feet;
5. 296° 09' 31" 679.32 feet along the Northeast side of Honoapiilani Highway Realignment, Phase 1B-2, Project No. NH-030-1(051), along the remainder of Lot 7 of the Launiupoko (Large-Lot) Subdivision No. 2;
6. Thence along same on a curve to the right with a radius of 1,805.00 feet, the chord azimuth and distance being:  
  
315° 04' 14.5" 1,170.06 feet;
7. 333° 58' 58" 410.36 feet along the Northeast side of Honoapiilani Highway Realignment, Phase 1B-2, Project No. NH-030-1(051), along the remainder of Lot 7 of the Launiupoko (Large-Lot) Subdivision No. 2;
8. 243° 58' 58" 75.00 feet along same;
9. 330° 35' 13" 728.99 feet along same;
10. 42° 41' 30" 55.00 feet along same;
11. 312° 41' 30" 166.21 feet along same;
12. 42° 41' 30" 15.00 feet along same;
13. 132° 41' 30" 90.90 feet along the Northeast side of Lahaina-Wailuku Road, F.A.P. No. 30-A;

HONOAPIILANI HIGHWAY REALIGNMENT, PHASE 1B-2  
Federal Aid Project No. NH-030-1(051)  
Parcel 1

14. 42° 41' 30" 10.00 feet along same;
15. 132° 41' 30" 716.47 feet along same;
16. Thence along same on a curve to the left with a radius of  
2,183.59 feet, the chord azimuth  
and distance being:  
129° 35' 15" 236.49 feet;
17. 216° 29' 00" 5.00 feet along the Northeast side of  
Lahaina-Wailuku Road,  
F.A.P. No. 30-A;
18. 243° 58' 58" 72.42 feet along the Southwest side of  
Honoapiilani Highway Realignment,  
Phase 1B-2, Project No.  
NH-030-1(051), along the remainder  
of Lot 7 of the Launiupoko  
(Large-Lot) Subdivision No. 2;
19. 153° 58' 58" 191.69 feet along same;
20. 63° 58' 58" 30.00 feet along same;
21. 153° 58' 58" 160.34 feet along same;
22. Thence along same on a curve to the left with a radius of  
1,565.00 feet, the chord azimuth  
and distance being:  
135° 04' 14.5" 1,014.49 feet;
23. 116° 19' 31" 48.54 feet along the Southwest side of  
Honoapiilani Highway Realignment,  
Phase 1B-2, Project No.  
NH-030-1(051), along the remainder  
of Lot 7 of the Launiupoko  
(Large-Lot) Subdivision No. 2;
24. 26° 09' 31" 188.44 feet along the East side of South  
Connector Road, along the remainder  
of Lot 7 of the Launiupoko  
(Large-Lot) Subdivision No. 2;

HONOAPIILANI HIGHWAY REALIGNMENT, PHASE 1B-2  
Federal Aid Project No. NH-030-1(051)  
Parcel 1

25. Thence along same on a curve to the right with a radius of 713.05 feet, the chord azimuth and distance being:  
27° 49' 31" 41.48 feet;
26. 119° 29' 31" 35.00 feet along same;
27. Thence along the East side of South Connector Road on a curve to the right with a radius of 678.05 feet, the chord azimuth and distance being:  
31° 40' 25.5" 51.63 feet;
28. Thence along same on a curve to the right with a radius of 678.05 feet, the chord azimuth and distance being:  
35° 16' 05" 33.43 feet;
29. Thence along same on a curve to the right with a radius of 678.05 feet, the chord azimuth and distance being:  
53° 40' 01.5" 396.18 feet;
30. 340° 39' 13" 62.88 feet along the East side of South Connector Road, along the remainder of Lot 7 of the Launiupoko (Large-Lot) Subdivision No. 2;
31. 105° 29' 00" 176.50 feet along the North side of Lahaina-Wailuku Road, F.A.P. No. 30-A;
32. Thence along same on a curve to the right with a radius of 2,609.42 feet, the chord azimuth and distance being:  
108° 59' 48.5" 319.83 feet;
33. 202° 30' 37" 15.00 feet along the West side of South Connector Road, along the remainder of Lot 7 of the Launiupoko (Large-Lot) Subdivision No. 2;



HONOAPIILANI HIGHWAY REALIGNMENT, PHASE 1B-2  
Federal Aid Project No. NH-030-1(051)  
Parcel 1

34. Thence along same on a curve to the left with a radius of 578.05 feet, the chord azimuth and distance being:

257° 15' 09" 667.37 feet;

35. Thence along same on a curve to the left with a radius of 578.05 feet, the chord azimuth and distance being:

220° 15' 25" 35.06 feet;

36. Thence along same on a curve to the left with a radius of 578.05 feet, the chord azimuth and distance being:

212° 20' 20" 124.46 feet;

37. 206° 09' 31" 188.44 feet along the West side of South Connector Road, along the remainder of Lot 7 of the Launiupoko (Large-Lot) Subdivision No. 2;

38. 116° 09' 31" 134.75 feet along the Southwest side of Honoapiilani Highway Realignment, Phase 1B-2, Project No. NH-030-1(051), along the remainder of Lot 7 of the Launiupoko (Large-Lot) Subdivision No. 2;

39. 206° 09' 31" 30.00 feet along same;

40. 116° 09' 31" 361.03 feet along same;

41. Thence along same on a curve to the right with a radius of 3,074.67 feet, the chord azimuth and distance being:

138° 21' 28.5" 2,323.40 feet;

HONOAPIILANI HIGHWAY REALIGNMENT, PHASE 1B-2  
Federal Aid Project No. NH-030-1(051)  
Parcel 1

42. 106° 48' 15" 135.15 feet along the Southwest side of  
Honoapiilani Highway Realignment,  
Phase 1B-2, Project No.  
NH-030-1(051), along the remainder  
of Lot 7 of the Launiupoko  
(Large-Lot) Subdivision No. 2;
43. 161° 59' 16" 549.39 feet along same;
44. 226° 59' 16" 143.44 feet along same;
45. 161° 59' 16" 9.14 feet along same;
46. Thence along the South side of Kai Hele Ku Street (Lot B-2)  
Mahanalua Subdivision on a curve to  
the left with a radius of 530.00  
feet, the chord azimuth and  
distance being:  
  
257° 08' 53.75" 76.60 feet;
47. 253° 00' 16" 8.71 feet along same;
48. 253° 00' 16" 115.55 feet along same, to the point of  
beginning and containing an area of  
1,453,712 square feet or 33.373  
acres.

Together with any and all abutter's rights of vehicle access  
appurtenant to the reminder of the land of which Parcel 1 is a  
part, into and from Honoapiilani Highway Realignment, Phase 1B-2,  
Federal Aid Project No. NH-030-1(051), Hokiokio Place to Vicinity  
of Olowalu, over and across Courses 4-12 (inclusive), 18 to 27  
(inclusive), 29, 30, 33, 34, 36 to 45 (inclusive) of the above  
described Parcel 1.

STATE OF HAWAII  
DEPARTMENT OF TRANSPORTATION  
Highways Division

January 30, 2018  
Honolulu, Hawaii  
Tax Map Key: (2)4-7-01:030

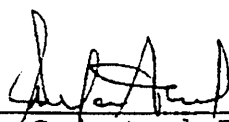
By   
for Cadastral Engineer

1. HONOLULU  
 2. MAUI  
 3. OAHU  
 4. KAUAI  
 5. NIIHAU  
 6. KAUAI  
 7. NIIHAU  
 8. KAUAI  
 9. NIIHAU  
 10. KAUAI  
 11. NIIHAU  
 12. KAUAI  
 13. NIIHAU  
 14. KAUAI  
 15. NIIHAU  
 16. KAUAI  
 17. NIIHAU  
 18. KAUAI  
 19. NIIHAU  
 20. KAUAI  
 21. NIIHAU  
 22. KAUAI  
 23. NIIHAU  
 24. KAUAI  
 25. NIIHAU  
 26. KAUAI  
 27. NIIHAU  
 28. KAUAI  
 29. NIIHAU  
 30. KAUAI  
 31. NIIHAU  
 32. KAUAI  
 33. NIIHAU  
 34. KAUAI  
 35. NIIHAU  
 36. KAUAI  
 37. NIIHAU  
 38. KAUAI  
 39. NIIHAU  
 40. KAUAI  
 41. NIIHAU  
 42. KAUAI  
 43. NIIHAU  
 44. KAUAI  
 45. NIIHAU  
 46. KAUAI  
 47. NIIHAU  
 48. KAUAI  
 49. NIIHAU  
 50. KAUAI  
 51. NIIHAU  
 52. KAUAI  
 53. NIIHAU  
 54. KAUAI  
 55. NIIHAU  
 56. KAUAI  
 57. NIIHAU  
 58. KAUAI  
 59. NIIHAU  
 60. KAUAI  
 61. NIIHAU  
 62. KAUAI  
 63. NIIHAU  
 64. KAUAI  
 65. NIIHAU  
 66. KAUAI  
 67. NIIHAU  
 68. KAUAI  
 69. NIIHAU  
 70. KAUAI  
 71. NIIHAU  
 72. KAUAI  
 73. NIIHAU  
 74. KAUAI  
 75. NIIHAU  
 76. KAUAI  
 77. NIIHAU  
 78. KAUAI  
 79. NIIHAU  
 80. KAUAI  
 81. NIIHAU  
 82. KAUAI  
 83. NIIHAU  
 84. KAUAI  
 85. NIIHAU  
 86. KAUAI  
 87. NIIHAU  
 88. KAUAI  
 89. NIIHAU  
 90. KAUAI  
 91. NIIHAU  
 92. KAUAI  
 93. NIIHAU  
 94. KAUAI  
 95. NIIHAU  
 96. KAUAI  
 97. NIIHAU  
 98. KAUAI  
 99. NIIHAU  
 100. KAUAI



STATE OF HAWAII



DEPARTMENT OF TRANSPORTATION

HIGHWAYS DIVISION

HONOLULU, HAWAII

RIGHT OF WAY MAP

HONOAPILANI HIGHWAY REALIGNMENT, PHASE 1B-2  
 HOKIOKIO PLACE TO VICINITY OF OLOWALU

Federal Aid Project No. NH-030-1(051)

COUNTY OF MAUI PARCEL

LAUNUPOKO, LAHAINA, MAUI, HAWAII

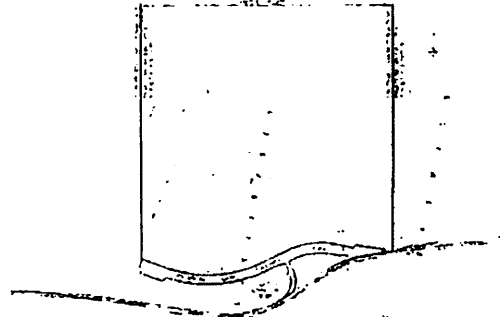

LOCATION PLAN  
 OF 15 SHEETS

DEPARTMENT OF TRANSPORTATION  
 STATE OF HAWAII  
 APPROVED: DATE: 10/10/01  
 SHEET NO. 15 OF 15 SHEETS

EXHIBIT A-2

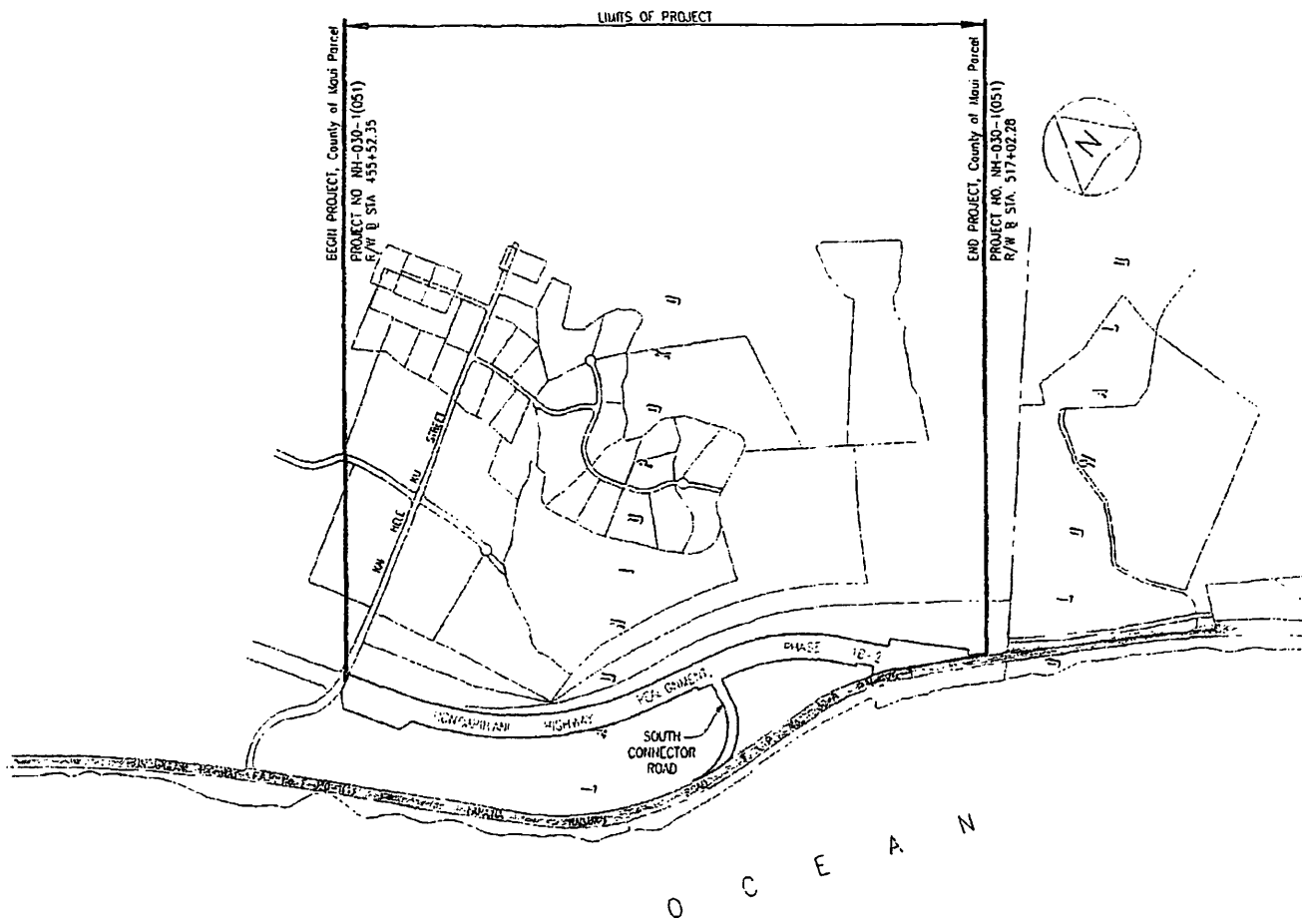

## LOCATION PLAN

NOT TO SCALE



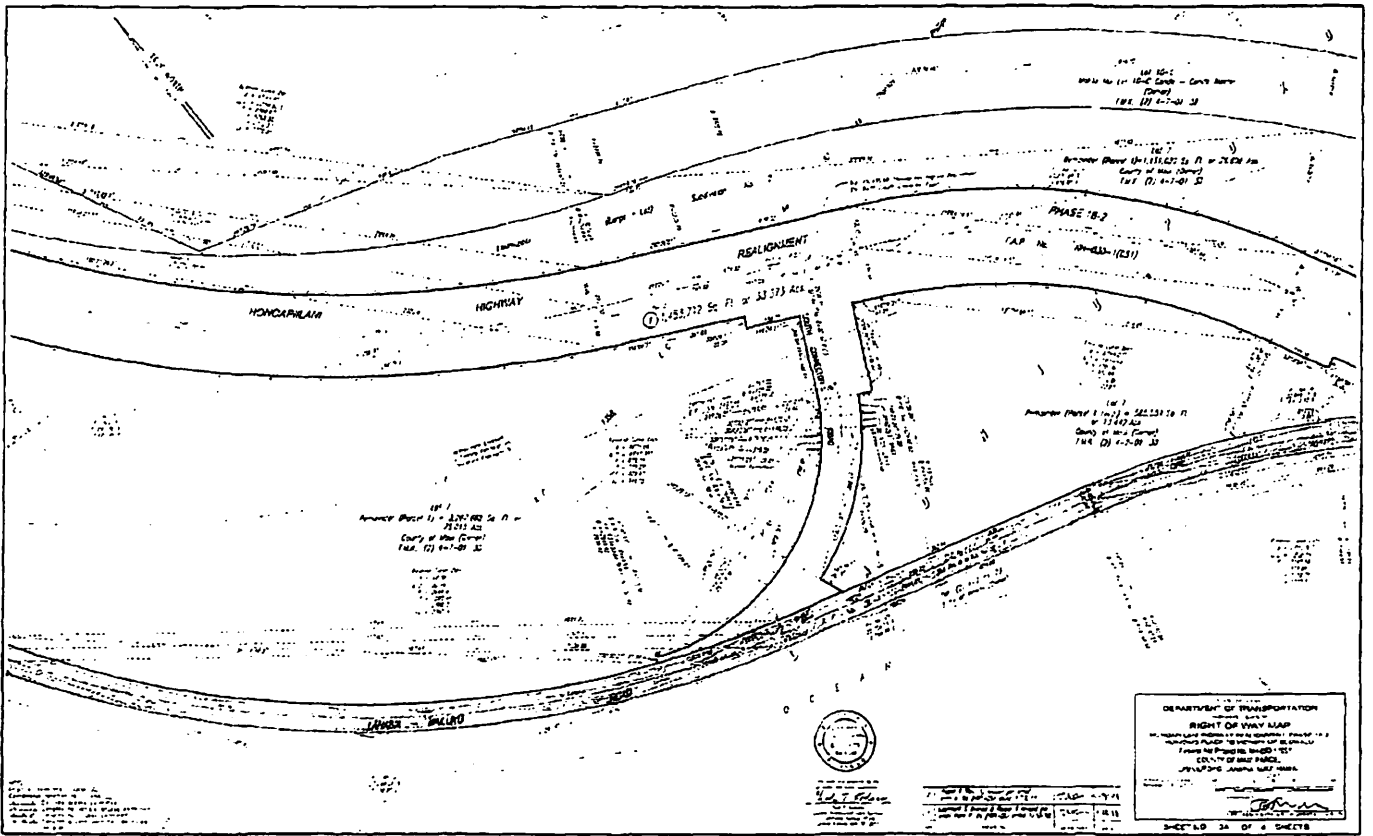

DEPARTMENT OF TRANSPORTATION  
RIGHT OF WAY MAP  
HONOLULU, TERRITORY OF HAWAII  
COUNTY OF HAWAII  
SHEET NO. 3A OF 4 SHEETS

100'

100'

