

MICHAEL P. VICTORINO  
Mayor

SCOTT K. TERUYA  
Director

MAY-ANNE A. ALIBIN  
Deputy Director



DEPARTMENT OF FINANCE  
COUNTY OF MAUI  
200 S. HIGH STREET  
WAILUKU, MAUI, HAWAII 96793  
[www.maui-county.gov](http://www.maui-county.gov)

2022 JUN -6 AM 9:40

RECEIVED

OFFICE OF THE  
COUNTY CLERK

June 1, 2022

Honorable Michael P. Victorino  
Mayor, County of Maui  
200 South High Street  
Wailuku, Hawaii 96793

APPROVED FOR TRANSMITTAL

*Michael P Victorino* 6/1/22  
\_\_\_\_\_  
Mayor Date

For Transmittal to:

Honorable Alice L. Lee, Chair  
And Members of the Maui County Council  
200 South High Street  
Wailuku, Hawaii 96793

Dear Chair Lee and Maui County Council Members:

**SUBJECT: MALUHIA AT WAILEA  
SEWERLINE EASEMENT M  
TMK: (2) 2-1-008:062 POR**

Pursuant to Section 3.44.015 H. of the Maui County Code, this letter shall serve as notice that the County of Maui has accepted the Dedication of an Easement for Sewerline Purposes by the Department of Environmental Management – Wastewater Reclamation Section. The parcel is identified by the subject Tax Map Key Number.

Please refer to enclosed Exhibit A for the Legal Description, Exhibit A-1 of an Easement Map & Property Location and Exhibit B of the Transfer Certificates of Title of the easement.

In addition, the Department of Environmental Management has provided additional information pursuant to Section 3.44.015, F.1 of the Maui County Code.

- 1) **County Funds**: No County Funds used.
- 2) **Project Name**: Maluhia at Wailea

COUNTY COMMUNICATION NO. 22-145

Sewerline Easement M  
TMK: (2) 2-1-008:062 POR  
June 1, 2022  
Page 2

- 3) **Purpose**: For Underground Sewerline Purposes, including manholes and other equipment and appurtenance necessary or expedient for the proper maintenance, operation or repair of such underground sewer pipelines.

The sewer system improvements within Sewerline Easement M serves the entire Wailea and Makena County sewer system improvements.

- 4) **Dedication**: Sewer system improvements consisting of a 21" Reinforced Concrete Sewerline installed in 1973. All of the sewer system improvements are confirmed to be located within stated easement areas.

- 5) **Conformance**: Easement locations and widths are acceptable to the Department of Environmental Management and are in conformance with County standards.

Thank you for your attention in this matter. Should you have any questions, please feel free to contact me at Ext. 7474.

Sincerely,



SCOTT K. TERUYA  
Director of Finance

Enclosures

Cc: Eric Nakagawa, Director of Environmental Management

SKT/gmh

**EXHIBIT "A"**

Easement M, area of 0.235 acres more or less, as shown on Map 5 and as set forth by Land Court Order No. 37357 filed in the Land Court on April 27, 1973 as amended by Land Court Order No. 47774, filed July 26, 1977, affecting Lot 216, as shown on Map 31, of Land Court Application 1804 of Matson Navigation Company, and also described in and covered by Transfer Certificates of Title listed in Exhibit "B" attached hereto.

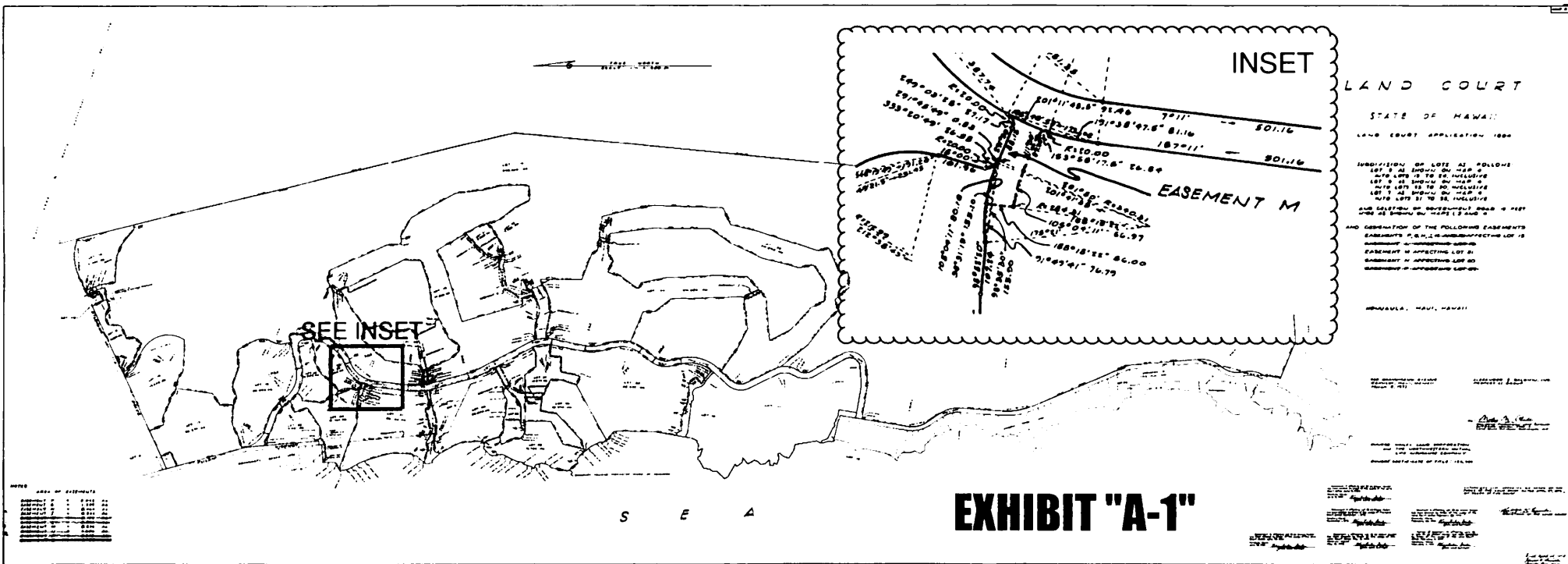

**EXHIBIT "B"**

<b>Unit No.</b>	<b>TCTNo.</b>
1	722018
2	638650
3	762221
4	909625
5	753092
6	789577
7	779811
8	910107
9	814162
10	691375
11	574023
12	574169
13	766779
14	848841