

MICHAEL P. VICTORINO
Mayor

SCOTT K. TERUYA
Director

MAY-ANNE A. ALIBIN
Deputy Director

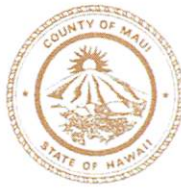

DEPARTMENT OF FINANCE
COUNTY OF MAUI
200 S. HIGH STREET
WAILUKU, MAUI, HAWAII 96793
www.mauicounty.gov

November 24, 2020

Honorable Michael P. Victorino
Mayor, County of Maui
200 South High Street
Wailuku, Hawaii 96793

APPROVED FOR TRANSMITTAL

Michael P. Victorino 11/25/20
Mayor Date

For Transmittal to:

Honorable Alice L. Lee, Chair
And Members of the Maui County Council
200 South High Street
Wailuku, Hawaii 96793

Dear Chair Lee and Maui County Council Members:

**SUBJECT: KEHALANI MODULES 12 & 13, LOT 167
WATERLINE EASEMENT M
TMK: (2) 3-5-001:108 POR & 109 POR**

Pursuant to Section 3.44.015 H. of the Maui County Code, this letter shall serve as notice that the County of Maui has accepted the dedication of (1) One Waterline Easement by the Department of Water Supply – Engineering Division. The easement is identified by the subject Tax Map Key Number.

Please refer to enclosed Exhibit A for the Legal Description and Exhibit B for the Location of the Easement.

In addition, the Department of Water Supply has provided additional information pursuant to Section 3.44.015, F.2 of the Maui County Code.

- 1) **County Funds**: No County funds used.
- 2) **Purpose**: For access to water meter and waterline purposes, including other equipment and appurtenances necessary or expedient for the proper maintenance, operation or repair of such water meter or pipelines installed within said Easement Area in connection with the

COUNTY COMMUNICATION NO. 20-587

construction of the Kehalani Modules 12 & 13 Subdivision, Subdivision
File No. 3.2387.

- 3) **Conformance**: Easement location and width is acceptable to the
Department of Water Supply and are in conformance with County
standards.

Thank you for your attention in this matter. Should you have any
questions, please feel free to contact me at Ext. 7474.

Sincerely,



SCOTT K. TERUYA
Director of Finance

Enclosures
SKT/gmh

Cc: Jeffrey T. Pearson, Department of Water Supply Director

Kehalani Modules 12 and 13 Subdivision
Description of Lot 167
Easement "M"

Being a portion of Grant 483 to E. Bailey.

1. 332° 53' 24" 41.41 feet along Lot 130 of Kehalani Modules 12 and 13 Subdivision, being also along the remainder of Grant 483 to E. Bailey to a point;
2. Thence along same on a curve to the left, with the point of curvature azimuth from the radial point being: 62° 53' 24", and the point of tangency azimuth from the radial point being: 15° 45' 26", having a radius of 30.00 feet, the chord azimuth and distance being: 309° 19' 25" 23.99 feet to a point;
3. 72° 12' 39.48 feet along Lot D-1 of Kehalani Mauka (Large-Lot) Subdivision No. 3-B, being also along the remainder of Grant 483 to E. Bailey to a point;

4. Thence along Lot 129 of Kehalani Modules 12 and 13 Subdivision, being also along the remainder of Grant 483 to E. Bailey on a curve to the left, with the point of curvature azimuth from the radial point being: $300^{\circ} 47' 26''$, and the point of tangency azimuth from the radial point being: $242^{\circ} 53' 24''$, having a radius of 20.00 feet, the chord azimuth and distance being: $181^{\circ} 50' 25''$ 19.36 feet to a point;
5. $152^{\circ} 53' 24''$ 35.26 feet along same to a point;
6. Thence along Lot 171 (Laniuma Place) of Kehalani Modules 12 and 13 Subdivision, being also along the remainder of Grant 483 to E. Bailey on a curve to the left, with the point of curvature azimuth from the radial point being: $332^{\circ} 53' 24''$, and the point of tangency azimuth from the radial point being: $305^{\circ} 51' 16''$, having a radius of 44.00 feet, the chord azimuth and distance being: $229^{\circ} 22' 20''$ 20.57 feet to the point of beginning and containing an Area of 1,250 Square Feet.

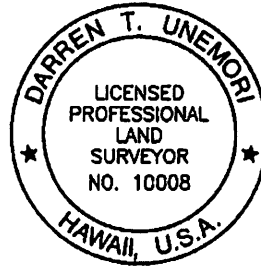

WARREN S. UNEMORI ENGINEERING, INC.

Wells Street Professional Center
2145 Wells Street, Suite 403
Wailuku, Maui, Hawaii 96793
March 19, 2020

By:  4/30/22 Exp.
Licensed Professional Land Surveyor
Certificate No. 10008

Plat: Proprietary: 10008 Survey Descriptions Desc. of Lot 167 rev. 1/2020

TRUE NORTH
SCALE: 1 IN. = 200 FT.

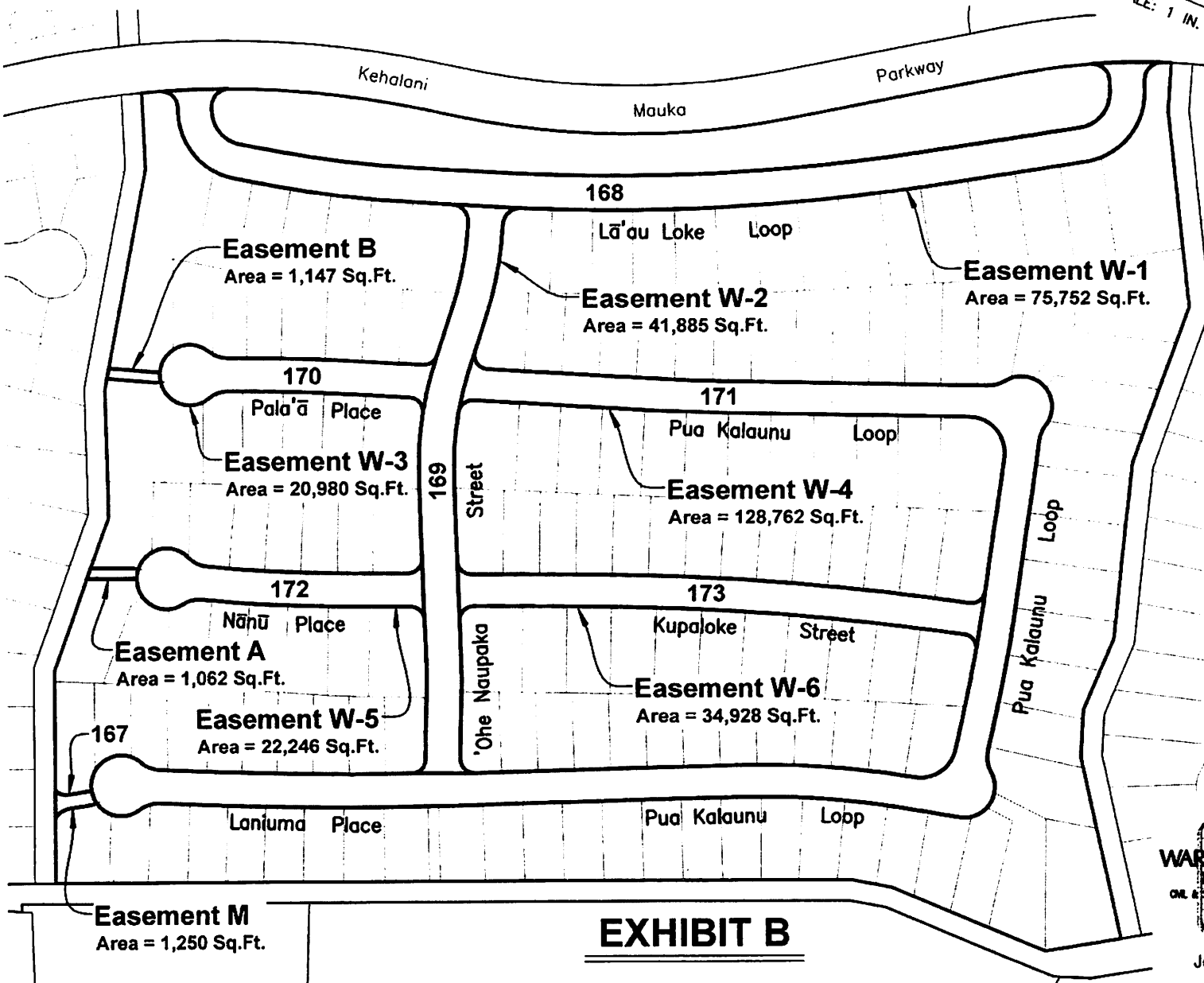
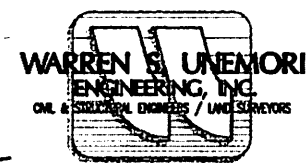

EXHIBIT B



January 28, 2020

V:\projdata\16proj\16075\dwg\exhibits\EXB-WATERLINE ESMT-00.dwg