

## IT Committee

---

**From:** Mark Roy <mark@munekiyohiraga.com>  
**Sent:** Wednesday, August 18, 2021 5:29 PM  
**To:** IT Committee  
**Cc:** Eric Nakagawa; Jordan Hart; Tracy Nakamoto; Nadine Orikasa  
**Subject:** IT-60: Central Maui Presentation File (PDF)  
**Attachments:** COM CM Landfill- 081921 Council Meeting PPP.Council.pdf

You don't often get email from mark@munekiyohiraga.com. [Learn why this is important](#)

Dear Committee Chair Sugimura,

At the request of the DEM Director's office, I'm respectfully submitting the attached presentation slides for tomorrow's IT Committee meeting (IT-60). I will be participating as a speaker in DEM's presentation for this particular (Central Maui Landfill) item and would like to screen share the attached slides during my portion of the presentation.

Thank you very much!

Sincerely,

**Mark Alexander Roy** AICP | LEED AP BD+C  
Vice President  
Email: [mark@munekiyohiraga.com](mailto:mark@munekiyohiraga.com)



**Maui:** 305 High Street, Suite 104, Wailuku, Hawaii 96793 **T:** 808.244.2015 **F:** 808.244.8729

**Oahu:** 735 Bishop Street, Suite 412, Honolulu, Hawaii 96813 **T:** 808.983.1233

Planning. Project Management. Sustainable Solutions. [www.munekiyohiraga.com](http://www.munekiyohiraga.com)

CONFIDENTIAL AND PRIVILEGED COMMUNICATION: This message (including attachments) is intended for the use of the designated recipient(s) named above. The contents of this correspondence are considered privileged and confidential. If you have received this message in error, kindly notify us immediately by email or telephone, and delete this email from your computer system. Thank you.

Due to the COVID-19 pandemic, if you have a document or package for delivery to our office via FedEx, UPS, or other courier service, please reach out to a MH team member to coordinate prior to sending. We are committed to providing our clients excellent service to further project goals and objectives during these challenging times. Please take care and stay safe. Mahalo.

# **State District Boundary Amendment Requirement for Central Maui Landfill IT-60**

***Maui County Council Infrastructure and  
Transportation Committee***

August 19, 2021



# CML Facilities Project – Site Location

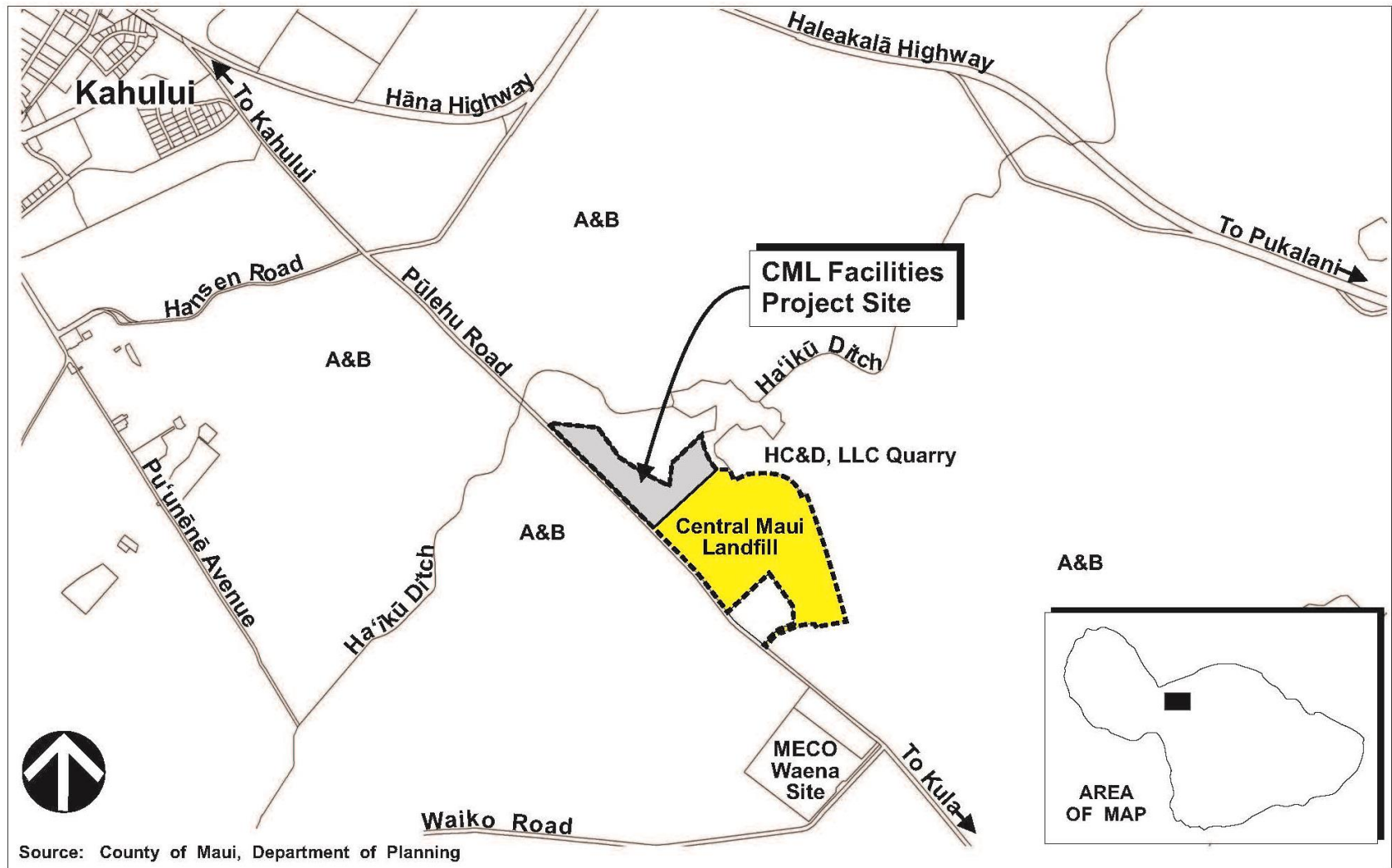

# CML Permitting History

- State Special Use Permits - SP86/359 and SP97-390
- County Special Use Permit - CUP 2008/0003

# CML Facilities Project - Need

- Consolidates DEM solid waste operations at a 40-acre site located adjacent to existing operations at Maui's main landfill
- Implements sustainability measures recommended in the County's ISWMP
- Project will increase diversion of waste from CML & extend landfill capacity

# CML Facilities Project - Site Plan

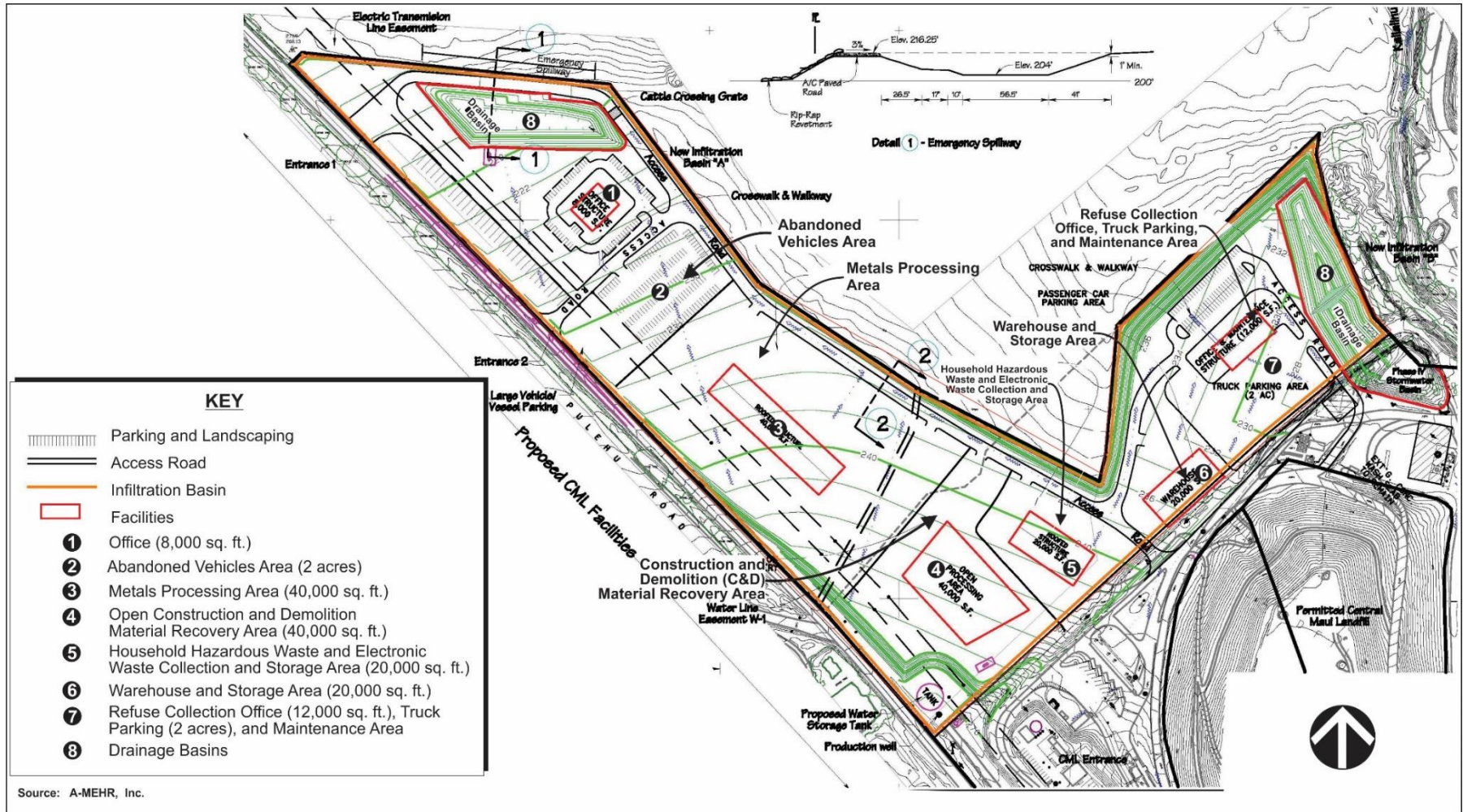

Source: A-MEHR, Inc.

# **CML Facilities Project - Permitting**

## **Chapter 343, HRS, Environmental Assessment (EA)**

- August 8, 2019 - Final EA/FONSI Published in OEQC's Environmental Notice

## **County Special Use Permit (CUP 2008/0003) and State Special Permit (SP97-390) Amendment Applications**

- Approved by Maui Planning Commission on December 10, 2019
- Approved by LUC on July 9, 2020

# SLUC District Boundary Amendment Requirement for CML

- As reflected in its Decision and Order (dated 8/13/20), the SLUC chose to add Condition No. 23 to its approval of the County's amendment request due to concerns relating to permanence of certain structures and uses at the CML:

***23. That the Applicant shall commence the process to seek a district boundary amendment with the LUC for the approximately 95.659 acres of the total permitted area of the CML within five years of the LUC's Decision and Order for the Applicant's Fourth Amendment Request***

A motion for reconsideration filed by the Office of Planning (on 8/31/20) maintained that Special Permits are the appropriate land use regulation mechanism for landfills - motion was unsuccessful with SLUC.



# **Mahalo**